

TECHNICAL SPECIFICATION SHEET





ISLAND SYSTEM.

The intelligent J'Sky ceiling integrates several innovative technologies, including cooling & heating, acoustics, lighting, ventilation, etc. into one sleek ceiling. The result: more space, limited installation costs and a comfortable working and living environment. This specification sheet contains all the technical information about the island system.

MATERIAL

- ▶ Ceiling panels made of steel with a microperforation of $\varnothing 0.7$ mm with free passage of 4%.
- ▶ Perforation possible up to the edge or continuous.

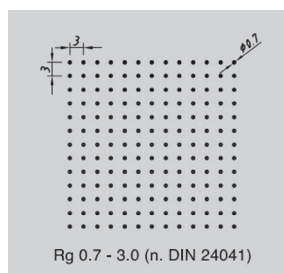

PANEL DIMENTIONS

Standard dimensions (LxWxH):

- ▶ 1,200x900x50 mm
- ▶ 1,800x900x50 mm
- ▶ 2,400x900x50 mm

Other dimensions in consultation.

EDGE FINISH AND PANEL TYPES

There are 2 possible edge finishes, a straight edge or beveled edge under 60° .

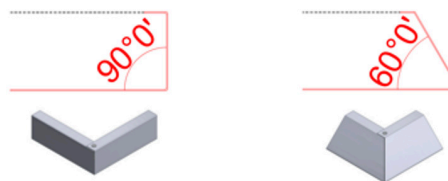

Possible panel types:

a	b	c	d	e
4 straight edges	4 beveled edges	3 sides straight 1 long side beveled	3 sides straight 1 short side beveled	2 long sides beveled 2 short sides straight
f	g	h	i	j
2 long sides straight 2 short sides beveled	Type 1 2 adjacent sides equal	Type 2 2 adjacent sides equal	3 sides beveled 1 short side straight	3 sides beveled 1 long side straight



Standard configurations:

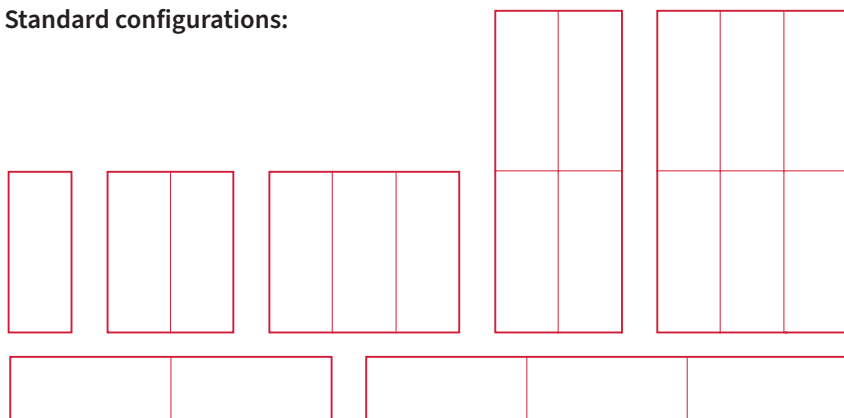

Between the adjacent panels, straight walls are provided as standard for a good connection. On the outside, beveled or straight edges can be chosen.

Other configurations in consultation.

Lighting options:

- ✦ Between panels
- ✦ Incorporated in panels or technical panel

Other integrations of construction technology e.g. ventilation, speakers, sensors, sprinklers, motion or fire detectors etc. are possible in consultation.

POWDER COATING

- ✦ Thermally cured powder coating in accordance with EN 13501-1 A1
- ✦ Minimum layer thickness of 60 µm and a gloss level of 20%
- ✦ The standard colour is RAL 9010.
- ✦ Other colours or decorative foil to fully personalize it are possible on request.

FIRE STABILITY & FIRE RESISTANCE

Fire stability and fire resistance certificates are available.

Fire stability: test under load-bearing structure > 30 minutes fire stability according to NBN 713.020. Test report No. 13975. Fire

resistance: classification A1, according to the standard EN13501-1. Classification report No. 16-901 0584-80

SUSTAINABILITY & WELL BEING PERFORMANCE

Significant contribution to BREEAM valuation through low energy consumption and recyclable materials. Improvement of the contribution of WELL valuation through the use of a radiation principle.





FALL PROTECTION

Panels are equipped with fall protection in order to be able to carry out work above the ceiling in a controlled and safe manner without the need to interrupt activation.

SUSPENSION CONSTRUCTION

- The L & Z suspension structure consists of an angle profile, Z-hook profile, IPM profile, threaded rod, impact anchor, bolts, nuts, and body washers.
- The u-profile suspension construction consists of a u-profile, threaded rod, strike anchor, nuts, and body washer.
- Minimum installation height:
 - L & Z structure: 150 mm
 - U-profile structure 70 mm
- A finishing frame can be provided to hide the suspension construction. This can be used to house LED lighting lines or other technologies.

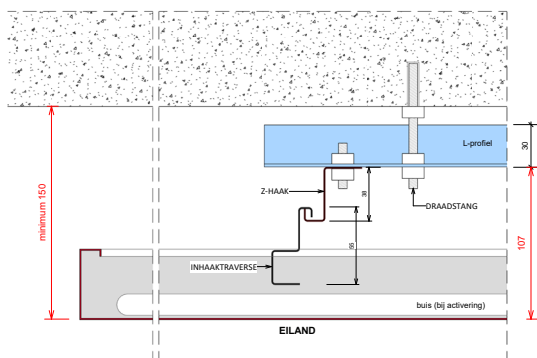

EILAND L&Z ophangstructuur
1 : 2

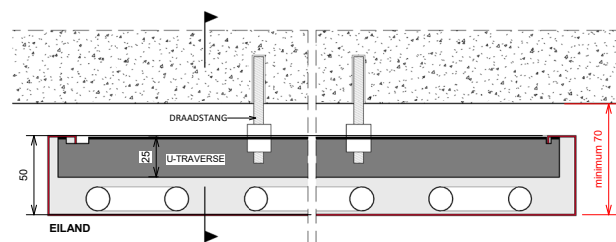
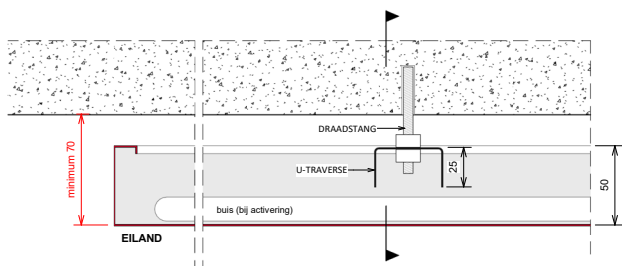

EILAND U-traverse
1 : 2



TECHNICAL DETAILS

- Cooling register with its own patented tube, glued into ceiling panel
- Tube diameter: 14.8 mm
- Tube spacing: 50, 75, or 100 mm

CAPACITY

CAPACITY	TUBE SPACING		
	50 MM	75 MM	100 MM
Cooling ($\Delta T = 10^\circ K$)	135W/m ²	116W/m ²	99W/m ²
Heating ($\Delta T = 15^\circ K$)	174W/m ²	161W/m ²	133W/m ²

The power is calculated according to the active surface as described in EN14037 and without acoustic insulation. Active surface = contact surface length of energy transfer element (AL) x tube spacing (d) x number of tube rows.

MINIMUM ACOUSTIC ABSORPTION (α_w)*

The panels are supplied with micro perforation and acoustic fleece as per standard. Optionally equipped with mineral wool sealed in PE film.

	α_w	Absorption class
With acoustic fleece	0.65	C
With rock wool, thickness 30 mm and density 45 kg/m ²	0.80	B
With rock wool and application of plasterboard 12.5 mm	0.75	C
With rock wool and application of steel plate 0.7 mm	0.75	C

Bij toepassing van isolatie in de eilandpanelen daalt vermogen bij koelen 12% en bij verwarmen 25%.

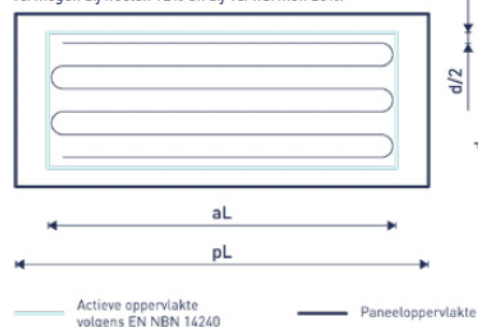

* carried out with a perforation pattern of 21% and 1.8 mm diameter



PROJECT APPROACH

Would you like to know more about specific project applications or can we help you think about a tailor-made project? Then contact us and we will be happy to help you!

BECOME A PARTNER

Interested in becoming a partner to install our climate ceilings? We are happy to train you through our Jansen Star Academy.

CONTACT US

ceilingsolutions@groupjansen.com

+32 11 79 92 00

www.jansenceilingsolutions.com

More information about our closed system?

Discover the technical data sheet on our website.